

AREA STATEMENT

TOTAL AREA OF THE PLOT = 3978.93 SQ.M.
 PROPOSED HEIGHT OF THE BUILDING = 59.65M.
 PERMISSIBLE GROUND COVERAGE = 1591.572 SQ. MTRS. (40%)
 PROPOSED GROUND COVERAGE = 1505.901 SQ. MTRS. (37.85%)
 NO. OF FLOORS = B1+B2+G+16
 COVERED CAR PARKING NOS. = (74+81) = 155 NOS.
 OPEN CAR PARKING NOS. = 40 NOS.

BUILT UP AREA

BASEMENT LOWER LVL. AREA = 3075.98 SQ.M.
 BASEMENT UPPER LVL. AREA = 3102.88 SQ.M.
 GROUND FLOOR AREA = 1389.69 SQ.M.
 1ST FLOOR AREA = 1394.83 SQ.M.
 2ND FLOOR AREA = 1464.37 SQ.M.
 3RD FLOOR AREA = 949.05 SQ.M.
 4TH - 14TH FLOOR AREA = 994.08 SQ.M.
 15TH - 16TH FLOOR AREA = 963.58 SQ.M.

PERMISSIBLE F.A.R. = 4
 PROPOSED AREA IN F.A.R. = 15876 SQ.M.
 PROPOSED F.A.R. = 3.99

LIST OF APARTMENTS

2 BHK APARTMENTS: 44 NOS.
 3 BHK APARTMENTS: 44 NOS.
 4 BHK APARTMENTS: 8 NOS.

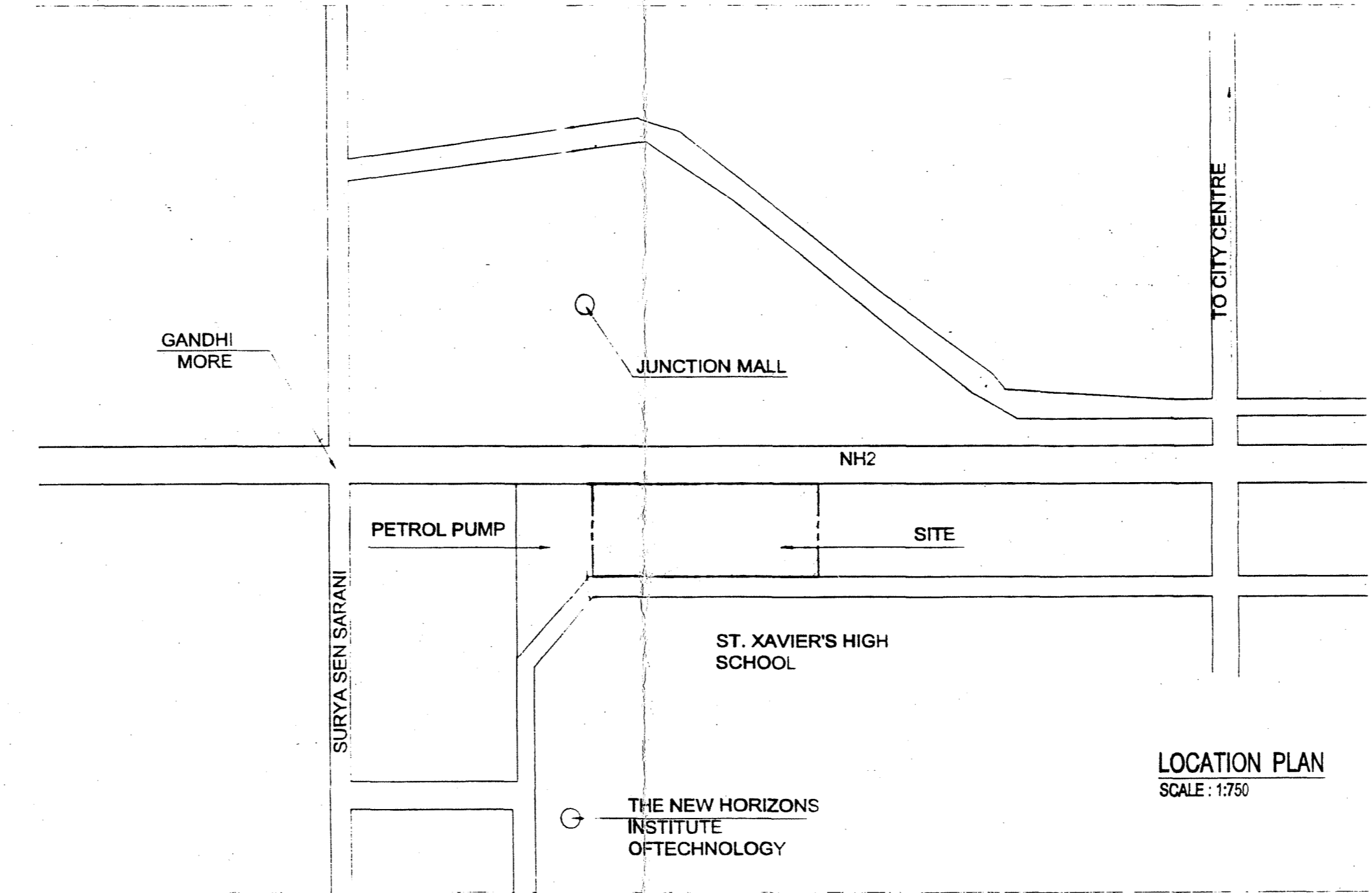
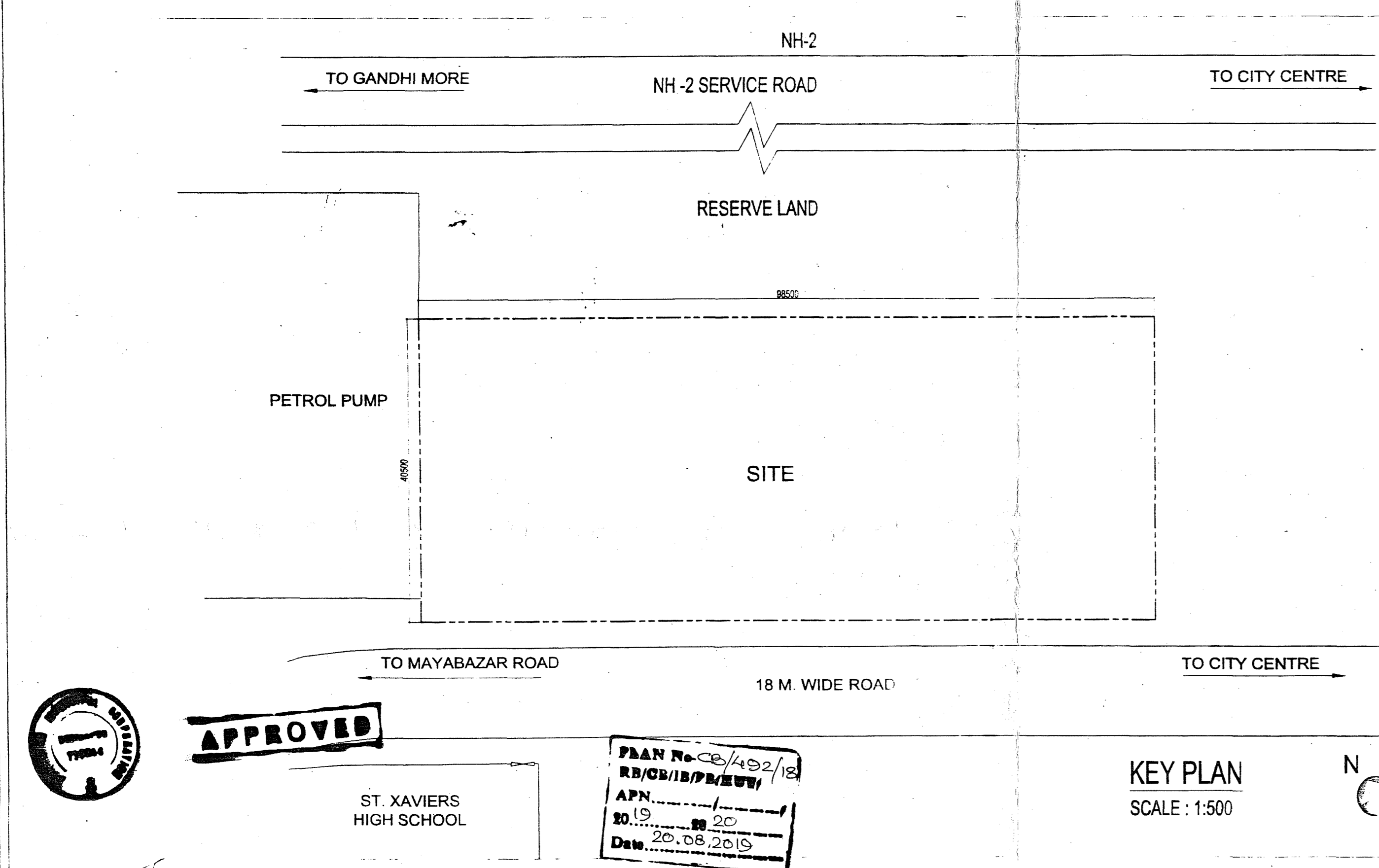

APPROVED
 ST. XAVIERS HIGH SCHOOL
 PLAN No. CB/142/18
 APN: 10/12/18/18/18/18
 10.12.18
 20.08.2018
 Date: 20.08.2018

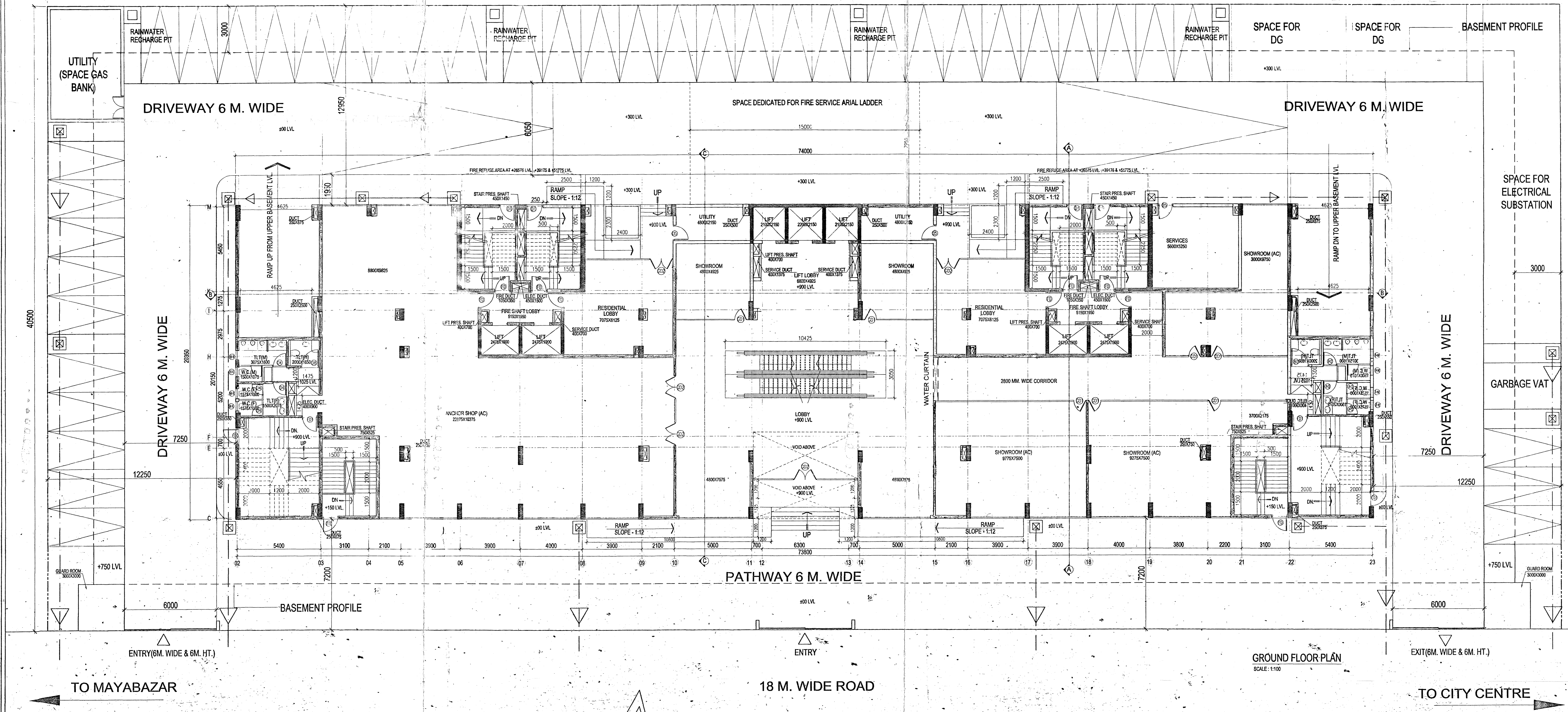

NOTES:
 ALL DIMENSIONS ARE IN MILLIMETERS
 ALL EXTERNAL WALLS ARE 200mm THICK
 ALL INTERNAL WALLS ARE 100mm THICK
 ALL CHANGERS ARE 400mm PROJECTED

WINDOW SCHEDULE				
NO.	OPENING SIZE	SILL HT.	INTEL HT.	TYPE
W1	1800X1350	750	2100	SLIDING WINDOW
W2	1500X1350	750	2100	SLIDING WINDOW
W3	900X1200	900	2100	SLIDING WINDOW
W4	600X600	1500	2100	LOUVERED WINDOW
W5	1800X450	1650	2100	SLIDING WINDOW

DOOR SCHEDULE				
NO.	OPENING SIZE	INTEL HT.	TYPE	
D1	1500X2100	2100	ANGLE LEAF PANEL DOOR	
D2	1200X2100	2100	ANGLE LEAF PANEL DOOR	
D3	900X2100	2100	ANGLE LEAF PANEL DOOR	
D4	1200X2100	2100	ANGLE LEAF PANEL DOOR	
D5	1200X2100	2100	ANGLE LEAF PANEL DOOR	
D6	1200X2100	2100	ANGLE LEAF PANEL DOOR	
D7	1200X2100	2100	ANGLE LEAF PANEL DOOR	
D8	1200X2100	2100	ANGLE LEAF PANEL DOOR	
D9	1200X2100	2100	ANGLE LEAF PANEL DOOR	
D10	1200X2100	2100	ANGLE LEAF PANEL DOOR	
D11	1200X2100	2100	ANGLE LEAF PANEL DOOR	
D12	1200X2100	2100	ANGLE LEAF PANEL DOOR	
D13	1200X2100	2100	ANGLE LEAF PANEL DOOR	
D14	1200X2100	2100	ANGLE LEAF PANEL DOOR	
D15	1200X2100	2100	ANGLE LEAF PANEL DOOR	
D16	1200X2100	2100	ANGLE LEAF PANEL DOOR	
D17	1200X2100	2100	ANGLE LEAF PANEL DOOR	
D18	1200X2100	2100	ANGLE LEAF PANEL DOOR	
D19	1200X2100	2100	ANGLE LEAF PANEL DOOR	
D20	1200X2100	2100	ANGLE LEAF PANEL DOOR	
D21	1200X2100	2100	ANGLE LEAF PANEL DOOR	
D22	1200X2100	2100	ANGLE LEAF PANEL DOOR	
D23	1200X2100	2100	ANGLE LEAF PANEL DOOR	
D24	1200X2100	2100	ANGLE LEAF PANEL DOOR	
D25	1200X2100	2100	ANGLE LEAF PANEL DOOR	
D26	1200X2100	2100	ANGLE LEAF PANEL DOOR	
D27	1200X2100	2100	ANGLE LEAF PANEL DOOR	
D28	1200X2100	2100	ANGLE LEAF PANEL DOOR	
D29	1200X2100	2100	ANGLE LEAF PANEL DOOR	
D30	1200X2100	2100	ANGLE LEAF PANEL DOOR	
D31	1200X2100	2100	ANGLE LEAF PANEL DOOR	
D32	1200X2100	2100	ANGLE LEAF PANEL DOOR	
D33	1200X2100	2100	ANGLE LEAF PANEL DOOR	
D34	1200X2100	2100	ANGLE LEAF PANEL DOOR	
D35	1200X2100	2100	ANGLE LEAF PANEL DOOR	
D36	1200X2100	2100	ANGLE LEAF PANEL DOOR	
D37	1200X2100	2100	ANGLE LEAF PANEL DOOR	
D38	1200X2100	2100	ANGLE LEAF PANEL DOOR	
D39	1200X2100	2100	ANGLE LEAF PANEL DOOR	
D40	1200X2100	2100	ANGLE LEAF PANEL DOOR	
D41	1200X2100	2100	ANGLE LEAF PANEL DOOR	
D42	1200X2100	2100	ANGLE LEAF PANEL DOOR	
D43	1200X2100	2100	ANGLE LEAF PANEL DOOR	
D44	1200X2100	2100	ANGLE LEAF PANEL DOOR	
D45	1200X2100	2100	ANGLE LEAF PANEL DOOR	
D46	1200X2100	2100	ANGLE LEAF PANEL DOOR	
D47	1200X2100	2100	ANGLE LEAF PANEL DOOR	
D48	1200X2100	2100	ANGLE LEAF PANEL DOOR	
D49	1200X2100	2100	ANGLE LEAF PANEL DOOR	
D50	1200X2100	2100	ANGLE LEAF PANEL DOOR	
D51	1200X2100	2100	ANGLE LEAF PANEL DOOR	
D52	1200X2100	2100	ANGLE LEAF PANEL DOOR	
D53	1200X2100	2100	ANGLE LEAF PANEL DOOR	
D54	1200X2100	2100	ANGLE LEAF PANEL DOOR	
D55	1200X2100	2100	ANGLE LEAF PANEL DOOR	
D56	1200X2100	2100	ANGLE LEAF PANEL DOOR	
D57	1200X2100	2100	ANGLE LEAF PANEL DOOR	
D58	1200X2100	2100	ANGLE LEAF PANEL DOOR	
D59	1200X2100	2100	ANGLE LEAF PANEL DOOR	
D60	1200X2100	2100	ANGLE LEAF PANEL DOOR	
D61	1200X2100	2100	ANGLE LEAF PANEL DOOR	
D62	1200X2100	2100	ANGLE LEAF PANEL DOOR	
D63	1200X2100	2100	ANGLE LEAF PANEL DOOR	
D64	1200X2100	2100	ANGLE LEAF PANEL DOOR	
D65	1200X2100	2100	ANGLE LEAF PANEL DOOR	
D66	1200X2100	2100	ANGLE LEAF PANEL DOOR	
D67	1200X2100	2100	ANGLE LEAF PANEL DOOR	
D68	1200X2100	2100	ANGLE LEAF PANEL DOOR	
D69	1200X2100	2100	ANGLE LEAF PANEL DOOR	
D70	1200X2100	2100	ANGLE LEAF PANEL DOOR	
D71	1200X2100	2100	ANGLE LEAF PANEL DOOR	
D72	1200X2100	2100	ANGLE LEAF PANEL DOOR	
D73	1200X2100	2100	ANGLE LEAF PANEL DOOR	
D74	1200X2100	2100	ANGLE LEAF PANEL DOOR	
D75	1200X2100	2100	ANGLE LEAF PANEL DOOR	
D76	1200X2100	2100	ANGLE LEAF PANEL DOOR	
D77	1200X2100	2100	ANGLE LEAF PANEL DOOR	
D78	1200X2100	2100	ANGLE LEAF PANEL DOOR	
D79	1200X2100	2100	ANGLE LEAF PANEL DOOR	
D80	1200X2100	2100	ANGLE LEAF PANEL DOOR	
D81	1200X2100	2100	ANGLE LEAF PANEL DOOR	
D82	1200X2100	2100	ANGLE LEAF PANEL DOOR	
D83	1200X2100	2100	ANGLE LEAF PANEL DOOR	
D84	1200X2100	2100	ANGLE LEAF PANEL DOOR	
D85	1200X2100	2100	ANGLE LEAF PANEL DOOR	
D86	1200X2100	2100	ANGLE LEAF PANEL DOOR	
D87	1200X2100	2100	ANGLE LEAF PANEL DOOR	
D88	1200X2100	2100	ANGLE LEAF PANEL DOOR	
D89	1200X2100	2100	ANGLE LEAF PANEL DOOR	
D90	1200X2100	2100	ANGLE LEAF PANEL DOOR	
D91	1200X2100	2100	ANGLE LEAF PANEL DOOR	
D92	1200X2100	2100	ANGLE LEAF PANEL DOOR	
D93	1200X2100	2100	ANGLE LEAF PANEL DOOR	
D94	1200X2100	2100	ANGLE LEAF PANEL DOOR	
D95	1200X2100	2100	ANGLE LEAF PANEL DOOR	
D96	1200X2100	2100	ANGLE LEAF PANEL DOOR	
D97	1200X2100	2100	ANGLE LEAF PANEL DOOR	
D98	1200X2100	2100	ANGLE LEAF PANEL DOOR	
D99	1200X2100	2100	ANGLE LEAF PANEL DOOR	
D100	1200X2100	2100	ANGLE LEAF PANEL DOOR	

CERTIFICATE BY THE OWNER
 CERTIFIED THAT I HAVE GONE THROUGH THE BUILDING RULES FOR DURGAPUR AND ALSO UNDERTAKE TO ABIDE BY THOSE RULES DURING AND AFTER THE CONSTRUCTION OF THE BUILDING.
 CERTIFIED THAT I SHALL NOT ON A LATER DATE MAKE ANY ADDITION AND ALTERATION TO THIS PLAN.
 DUTTA AUTOMOBILES
 Signature of Owner

CERTIFICATE BY STRUCTURAL ENGINEER
 CERTIFIED THAT THE STRUCTURAL DRAWING AND DESIGN & DRAWINGS OF BOTH THE FOUNDATION & SUPER STRUCTURE OF THE BUILDING HAVE BEEN MADE BY ME CONSIDERING THE SOIL TEST REPORT AND ALSO CONSIDERING ALL POSSIBLE LOADS, SEISMIC LOAD AND THE MOMENTS GENERATED BY THE PROPOSED STRUCTURES AS PER THE BUREAU OF INDIAN STANDARD AND THE NATIONAL BUILDING CODE OF INDIA & CERTIFIED THAT IT IS SAFE & STABLE IN ALL RESPECT & THESE PROVISIONS SHALL BE ADHERED TO DURING THE CONSTRUCTION.
 Signature of Structural Engineer

CERTIFICATE BY GEO TECHNICAL ENGINEER
 CERTIFIED THAT THE FOUNDATION AND SUPERSTRUCTURE OF THE BUILDING PROPOSED FOR CONSTRUCTION HAVE BEEN PERSONALLY INSPECTED AND SOIL CONDITION HAS BEEN CHECKED BY ME THAT WILL MAKE SUCH FOUNDATION AND SUPERSTRUCTURE SAFE IN ALL RESPECT INCLUDING THE CONSIDERATION OF BEARING CAPACITY AND SETTLEMENT OF SOIL AND OTHER CONDITIONS, IF ANY, CONFORMING TO ALL STIPULATIONS OF ALL RELEVANT IS CODE OF PRACTICE AND NATIONAL BUILDING CODE.
 Signature of Geo Technical Engineer

CERTIFICATE BY ARCHITECT
 CERTIFIED THAT THE PLAN HAS BEEN DESIGNED AND DRAWN UP STRICTLY ACCORDING TO THE BUILDING RULES OF DURGAPUR. CERTIFIED THAT THE FOUNDATION AND SUPERSTRUCTURE OF THE BUILDING HAS BEEN SO DESIGNED BY ME AS TO BE SAFE IN ALL RESPECT INCLUDING THE CONSIDERATION OF SAFE BEARING CAPACITY AND SETTLEMENT OF SOIL.
 Signature of Architect

PROJECT:
 PROPOSED B1+B2+G+16 STORIED RESIDENTIAL CUM PARTLY COMMERCIAL BUILDING OF "DUTTA AUTOMOBILES" AT MOUZA - FARIDPUR, J.L. NO. -74, P.S. - DURGAPUR, DIST - PASCHIM BARDHAMAN, LAYOUT PLAN NO. - C2/1 & C2/1A, C.S. PLOT NO. - 856(P), 854(P), 3030(P), KHATAN NO. - 1362, SUB REG. OFFICER, CITY CENTRE, DURGAPUR - 16
 HOLDING NO. 334/N, ASSESSMENT NO. 3309401403945
 WARD NO. 32, STREET RD 100, PALASDIHA, DURGAPUR 08

CONTENT:
 GROUND FLOOR, KEY PLAN & LOCATION PLAN

CLIENT:
 DUTTA AUTOMOBILES,
 NACHAN ROAD, DURGAPUR

Architects:
 SBA SPECTRA CONSULTANTS
 Architects, Planners, Engineers, Valuers.
 DA - 170, Salt Lake, Kolkata - 700 064.

SCALE	AS SHOWN	REVISION
DATE	02.03.2019	DRG. NO.
DEALT		
CHKD.		DBD/ARCH-01